

SHOPS AT SURFSIDE

2336 SURFSIDE BLVD

CAPE CORAL, FLORIDA



1,200 - 24,000 SF



RETAIL FOR LEASE



CALL FOR RATES

PROPERTY INFORMATION

Junior anchor spaces & outparcel available immediately!

Join Belk, Dollar Tree, Starbucks and more

Great visibility and signage opportunity

Located on Veterans Parkway adjacent to Sandoval community with over 1,500 units

Positioned amongst the highest average HH incomes and home values in Cape Coral

Veterans Pkwy Traffic Counts: 26,000 AADT

LQWEST.COM/SHOPS-AT-SURFSIDE

DEMOGRAPHICS

	<u>1-MILE</u>	<u>3-MILES</u>	<u>5-MILES</u>
Total Population	8,537	40,166	114,305
Avg Household Income	\$70,813	\$72,199	\$68,442
Total Households	2,949	14,516	44,275
Daytime Employees	810	4,959	19,984

(Applied Geographic Solutions 2018)



TOM STRAUSS, PRINCIPAL

D: 239.333.4370 @ M: 239.822.9978

tstrauss@lqwest.com @ [My Listings](#)

JESSICA MCEVOY, ASSOCIATE

D: 239.333.4374

jmcevoy@lqwest.com @ [My Listings](#)

LANDQWEST COMMERCIAL REAL ESTATE SERVICES @ 1614 COLONIAL BOULEVARD #101, FORT MYERS, FL 33907



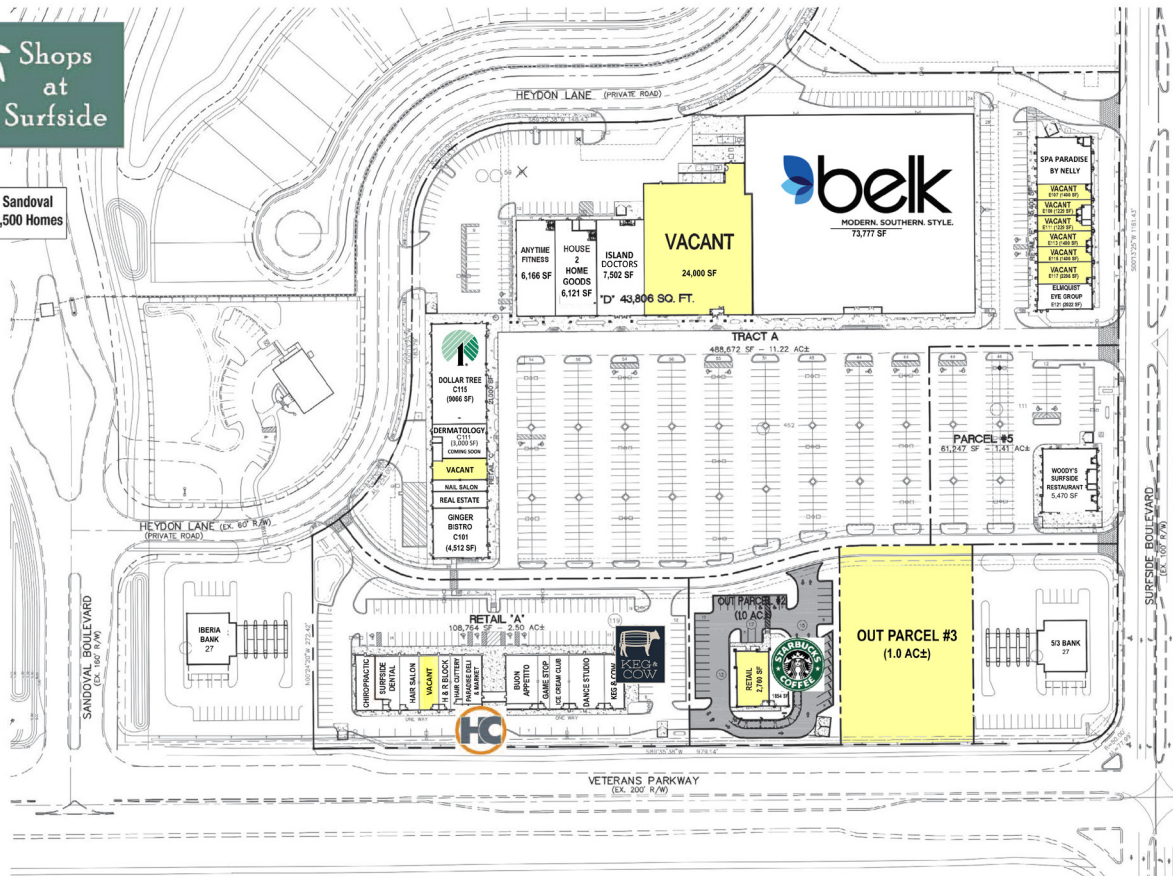

Suite #	SF	Vacant/Tenant
Retail "E"		
E101	4,079	Spa Paradise by Nelly
E107	1,400	VACANT
E109	1,229	VACANT
E111	1,229	VACANT
E113	1,400	VACANT
E115	1,400	VACANT
E117	2,206	VACANT
E121	2,022	Elmquist Eye Group



Information obtained from owner(s) or other sources deemed reliable. We have no reason to doubt its accuracy, but cannot guarantee it. All properties subject to change or withdrawal without notice.